

**The 46th Annual Meeting of the
Japanese Society of Intensive Care Medicine**

March 1-3, 2019/Kyoto, Japan



ENGLISH PROGRAM

MAP

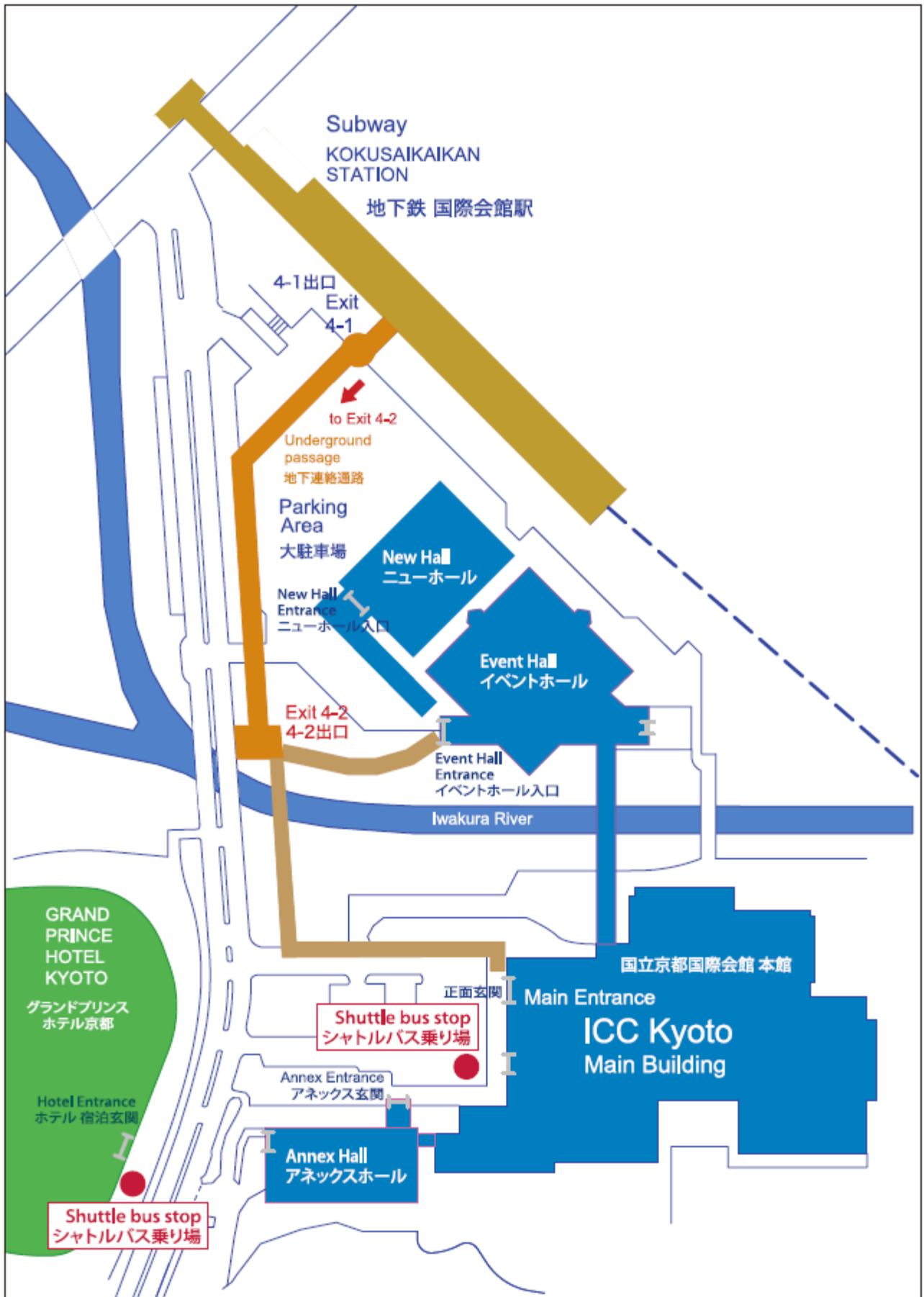

VENUE MAP

Kyoto International Conference Center

1F

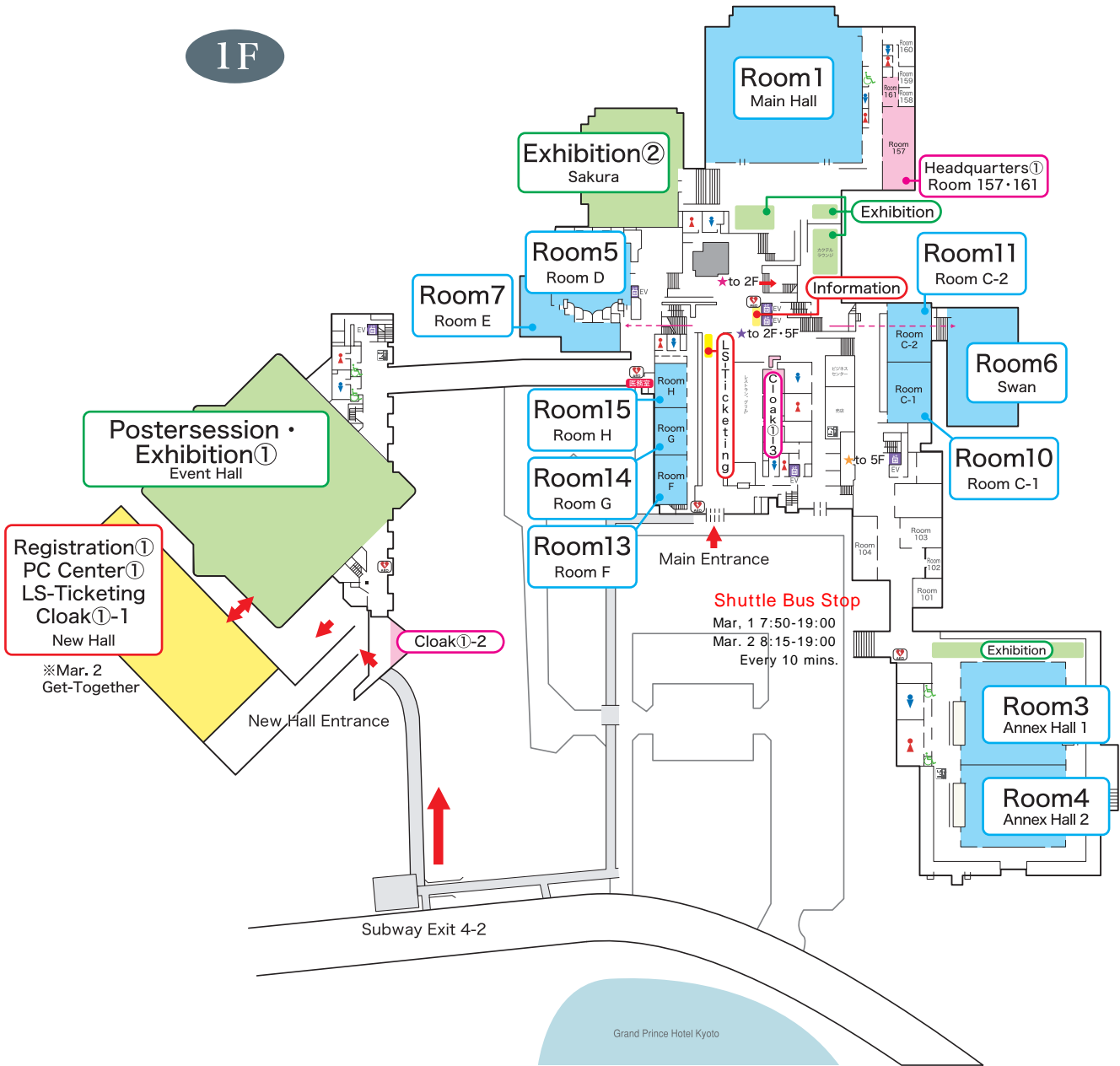

2F

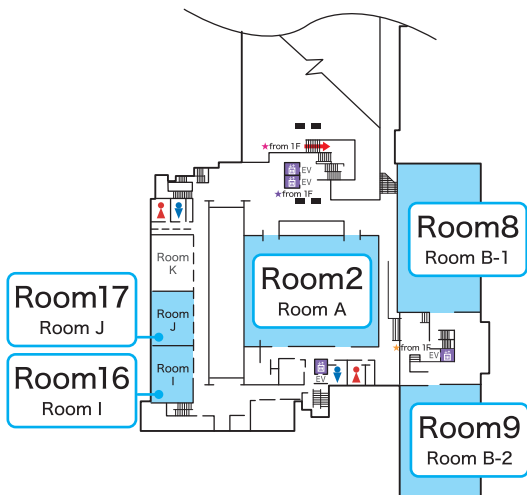

5F

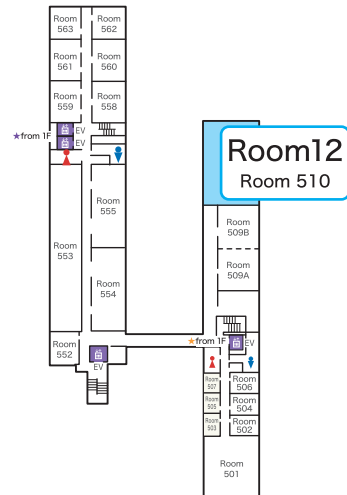

VENUE MAP

Grand Prince Hotel Kyoto

1F

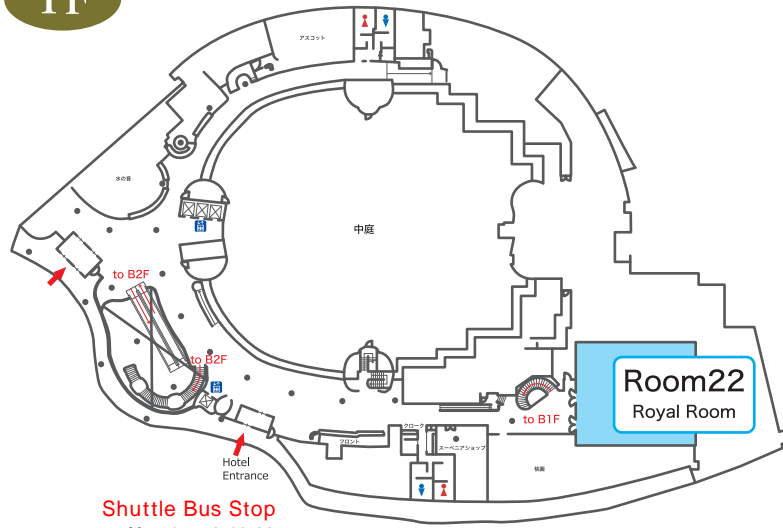

Shuttle Bus Stop
 Mar. 1 7:50-19:00
 Mar. 2 8:15-19:00
 Every 10 mins.

B1F

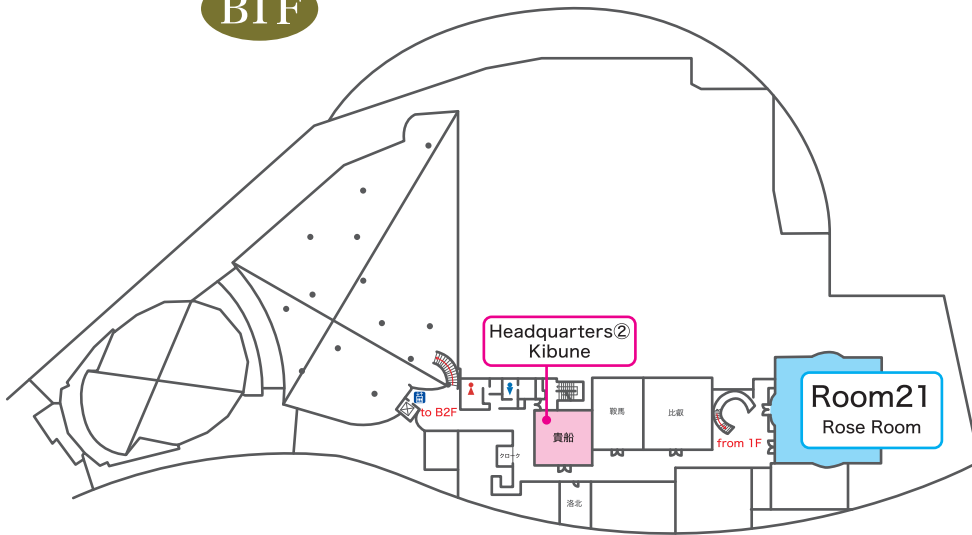

B2F

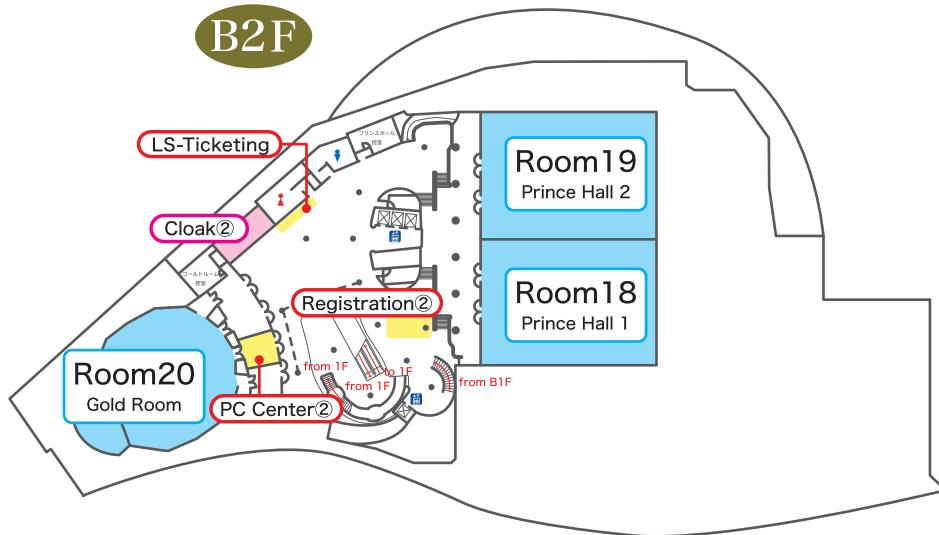

ANNOUNCEMENT FOR PARTICIPATION

1. Those without name cards cannot join the JSICM2019 Meeting.
2. Website application and online abstract book is available from February 20, 2019. Keyword for online search is 'jsicm46' or 'jsicm2019'. The designated password is required to access the online abstracts and will be announced to all the invited chairs and speakers and online registrants accordingly.
3. To join the <Presidential Program> Lunchtime Seminars & Luncheon Seminars, ticket will be required. Ticket-vending machines will be allocated near the registration desks and in the Main Entrance aisle of the Kyoto International Conference Center. Tickets will come to be invalid when the seminars start. Distribution time is as follows:

May 1 7 : 50~12 : 10

May 2 8 : 15~12 : 10

May 3 8 : 15~12 : 10 (Only at the Kyoto International Conference Center)

No tickets will be required for the evening seminars.

4. Cloak will be operated as follows:

	March 1	March 2	March 3
New Hall of the International Conference Center Kyoto	7 : 50~19 : 00	8 : 15~21 : 00	8 : 15~18 : 30
B2F Lobby of the Grand Prince Hotel Kyoto	7 : 50~18 : 30	8 : 15~18 : 30	×

7. Get-together Party will be held on March 2 evening in the New Hall of the Kyoto International Conference Center. It will start at 19 : 00.
8. Commercial Exhibition will be held in the Event Hall, Banquet Hall 'Sakura' (1F), Main Lounge (1F) and Lounge (1F), Medicine-Engineering Cooperative Exhibition in the Lobby of the Annex Hall of the Kyoto International Conference Center, and Book Sales Booth in the Event Hall and Banquet Hall 'Sakura' (1F) of the Kyoto International Conference Center and B2F Lobby of the Grand Prince Hotel Kyoto. The operation time is as follows:
May 1 9 : 00~19 : 00
May 2 8 : 30~19 : 00
May 3 9 : 00~16 : 00 (Only at the Kyoto International Conference Center)

9. Shuttle-bus service will be available on March 1 and 2 between the Main Entrance of the Kyoto International Conference Center and the Main Entrance of the Grand Prince Hotel Kyoto.

The operation time is as follows:

May 1 7 : 50~19 : 00 every 10 mins.

May 2 8 : 15~19 : 00 every 10 mins.

10. Travel Information Desk will be provided in the Main Lounge (1F) of the Kyoto International Conference Center.





The operation time is as follows:

May 1 9 : 00~18 : 00

May 2 9 : 00~18 : 00

May 3 9 : 00~16 : 00

11. Services to enhance the program proceeding will be available in the sessions with the following icon:

- 1)  : simultaneous translation between English and Japanese
- 2)  : ARS (audience response system)
- 3)  : live streamed (password appeared in the name card will be necessary; use earphone/on-demand streamed before March 3 24:00)
- 4)  : (only for the JSICM members/after the Meeting) on-demand streamed

12. Note:

- 1) No-smoking in the Meeting area
- 2) No cellphone in the presentation rooms
- 3) No paging
- 4) No recording, photographing and recording of the presentation materials

INSTRUCTIONS FOR CHAIRS & SPEAKERS

< Instructions for Chairs >

Be ready on the **Next Chairs' Seats** near the chairs' table in the assigned room **at latest 15 minutes prior to your session**.

Please be sure to organize your sessions according to the allocated time-schedule. Time-keeping system is available only for the English Sessions: Ten minutes (7 minutes presentation + 3 minutes discussion for each presentation).

<Instructions for Speakers >

All presentation and presentation data should be in English.

Time-keeping system is available for the English Sessions: Ten minutes (7 minutes presentation + 3 minutes discussion for each presentation).

Only PC presentation will be available. Slide projector, overhead projector and video CANNOT be used.

1) **Compatible personal computers**

*Windows: Bring your own PC or the data saved in the USB memory. Any other media cannot be used.

In order to avoid the virus infection, please scan your data with updated anti-virus software beforehand.

If your presentation data includes the video, please bring your own PC.

*Macintosh: Bring your own PC. DO NOT bring the data only.

2) **Video and sound**

Video and sound functions will be available.

3) **Instructions for those who bring the USB memory (Windows only)**

PCs with Windows 10 and Microsoft PowerPoint will be used. The monitor size is XGA (1024x768). Be sure that all the data appears on the screen without any defect under this environment.

<Fonts>

Times New Roman, Century, Century Gothic or Arial is highly recommended to avoid screen layout imbalance.

<Data Size>

The maximum data size is 640 MB.

<Registration of Presentation Data >

For registration of your presentation data, visit either PC Center.

Register your presentation data **at latest 30 minutes prior to your presentation**. Check that all your presentation data appears on the screen properly, especially if the data was originally created in a Macintosh and converted to the Windows format.

All installed data will be deleted by the Secretariat after the Meeting.

<At Your Presentation>

Be ready on the **Next Speakers' Seats** near the speaker's podium in the assigned room **at latest 15 minutes**

prior to your presentation.

PowerPoint and your presentation data will be ready on the speaker’s podium. Handle your presentation data by yourself, using the mouse and keyboard. Laser pointer will be available too. Note that the Presenter View CANNOT be used.

4) Instructions for those who bring their own PC

Bring your PC with the AC adaptor and auxiliary output adaptor (D-sub 15 pin). If necessary, be sure to bring a connector.

The monitor size is XGA (1024x768). For proper data projection, please adjust your screen setting to XGA. Cancel your screen saver, power saving setting and Wi-Fi connection in advance, especially if your data includes video and sound.

Be sure to **bring the back-up in Windows format for your data** just in case.

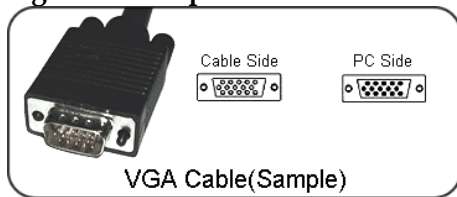

<Registration and Return of Personal Computer>

So as to test the connection and check your presentation data, visit either PC Center **at latest 30 minutes prior to your presentation.**

Your PC will be posted with a name tag by the PC staff to avoid the confusion. Bring your PC to the PC Desk of your presentation room, receive the receipt and pick up your PC **in exchange of the receipt** there. Be sure not to forget to pick up your PC.

<At Your Presentation>

Please be ready on the **Next Speakers’ Seats** near the speaker’s podium in the assigned room **at latest 15 minutes prior to your presentation.**

Your presentation data will be ready on the speaker’s podium. Handle your presentation data by yourself, using the mouse and keyboard. Presenter View cannot be used. Laser pointer will be available.

5) PC Center

	March 1	March 2	March 3
① International Conference Center New Hall	7:50-18:20	8:15-18:00	8:15-16:00
② Grand Prince Hotel Kyoto B2F	8:45-18:20	8:15-18:35	×

*Presentation data can be checked in at either Center.

★DO NOT bring the tablet nor smartphone.

★To avoid any trouble caused by the PC diversity, be sure to visit the PC Center.

PROGRAM

[Friday, March 1, 2019]

J⇔E simultaneous translation

BLDG	ROOM #	8:00	9:00	10:00	11:00	12:00	13:00	14:00	15:00	16:00	17:00	18:00	19:00	20:00
ICCKyoto	2		IL(E)1	SY1			Luncheon seminar	SP1	IL(E)2	IL(E)3	ME1			
	5		IL(E)4	IL(E)5	IL(E)6			IL(E)7	IL(E)8	IL(E)9	IL(E)10	ME2		
	11		EngO1	TSCCM-JSICM SY1	TSCCM-JSICM SY2		PLS1	EngO2	TSCCM-JSICM SY3	TSCCM-JSICM SY4				

[Saturday, March 2, 2019]

BLDG	ROOM #	8:00	9:00	10:00	11:00	12:00	13:00	14:00	15:00	16:00	17:00	18:00	19:00	20:00
ICCKyoto	2		IL(E)11	IL(E)12	IL(E)13		Luncheon seminar	IL(E)14	IL(E)15	IL(E)16				
	5		IL(E)17	IL(E)18			Luncheon seminar	PD7			ME3			
	11		EngO3	EngO4	EngO5		PLS2	EngO6	EngO7	EngO8	ME4			

[Sunday, March 3, 2019]

BLDG	ROOM #	8:00	9:00	10:00	11:00	12:00	13:00	14:00	15:00	16:00	17:00	18:00	19:00	20:00
ICCKyoto	2						Luncheon seminar							
	5		IL(E)20	SY18	IL(E)21									

[Invited Lecture]

March 1 (Fri) 9:00 ~ 9:50 Presentation Room 2 (Room A, Kyoto International Conference Center 2F)
Invited Lecture 1 (IL(E) 1) chaired by: Shin Nunomiya (Jichi Medical University)

**Simultaneous translation between English and Japanese available*

New sedation and delirium recommendations from the 2018 Society of Critical Care Medicine PADIS Guidelines
 Dale M. Needham (Johns Hopkins University, USA)

March 1 (Fri) 15:05 ~ 15:55 Presentation Room 2 (Room A, Kyoto International Conference Center 2F)
Invited Lecture 2 (IL(E) 2) chaired by: Yuji Fujino (Osaka University)

**Simultaneous translation between English and Japanese available*

What went wrong with ART, EPIVENT2 and PReVENT: Are the recent trials on lung protection contradicting lung physiology

Marcelo Britto Passos Amato (University of São Paulo Heart Institute (INCOR) , Brazil)

March 1 (Fri) 16:00 ~ 16:50 Presentation Room 2 (Room A, Kyoto International Conference Center 2F)
Invited Lecture 3 (IL(E) 3) chaired by: Ichiro Kuwahira (Tokai University)

**Simultaneous translation between English and Japanese available*

Electrical impedance tomography: The past, the present and the future

Inéz Frerichs (University Medical Centre Schleswig-Holstein, Germany)

March 1 (Fri) 9:00 ~ 10:00 Presentation Room 5 (Room D, Kyoto International Conference Center 1F)
Invited Lecture 4 (IL(E) 4) chaired by: Hiroshi Morimatsu (Okayama University)

**Simultaneous translation between English and Japanese available*

-1 Update from TSCCM: Current status of rapid response system in Thailand

Thammasak Thawitsri (Chulalongkorn University, Thailand)

-2 Update from TSCCM: Vasopressors in sepsis

Chairat Permpikul (Siriraj Hospital, Thailand)

March 1 (Fri) 10:05 ~ 10:55 Presentation Room 5 (Room D, Kyoto International Conference Center 1F)

Invited Lecture 5 (IL(E) 5) chaired by: Tetsu Gando (Sapporo Higashi Tokushukai Hospital)

**Simultaneous translation between English and Japanese available*

Tranexamic acid in life threatening bleeding

Ian Roberts (London School of Hygiene & Tropical Medicine, UK)

March 1 (Fri) 11:00 ~ 11:50 Presentation Room 5 (Room D, Kyoto International Conference Center 1F)

Invited Lecture 6 (IL(E) 6) chaired by: Satoshi Nakagawa (National Center for Child Health and Development)

**Simultaneous translation between English and Japanese available*

Moral distress: I know what to do but I can't !!!

Daniel Garros (University of Alberta Stollery Children's Hospital, Canada)

March 1 (Fri) 14:00 ~ 14:50 Presentation Room 5 (Room D, Kyoto International Conference Center 1F)

Invited Lecture 7 (IL(E) 7) chaired by: Tetsuya Sakamoto (Teikyo University)

**Simultaneous translation between English and Japanese available*

The 50th anniversary of ARDS: What has been changed?

Massimo Antonelli (Catholic University of the Sacred Heart, Italy)

March 1 (Fri) 14:55 ~ 15:45 Presentation Room 5 (Room D, Kyoto International Conference Center 1F)

Invited Lecture 8 (IL(E) 8) chaired by: Moritoki Egi (Kobe University Hospital)

**Simultaneous translation between English and Japanese available*

Acute glycemic control in patients with diabetes

Adam Deane (Royal Melbourne Hospital, University of Melbourne, Australia)

March 1 (Fri) 15:50 ~ 16:40 Presentation Room 5 (Room D, Kyoto International Conference Center 1F)

Invited Lecture 9 (IL(E) 9) chaired by: Shin Nunomiya (Jichi Medical University)

**Simultaneous translation between English and Japanese available*

Pain management in critical care; why, whom, and how? -The role of CPOT

Céline Gélinas (McGill University, Canada)

March 1 (Fri) 15:45 ~ 17:35 Presentation Room 5 (Room D, Kyoto International Conference Center 1F)

Invited Lecture 10 (IL(E) 10) chaired by: Kaneyuki Kawamae (Yamagata University)

**Simultaneous translation between English and Japanese available*

A multidisciplinary rehabilitation approach to facilitating early engagement and mobilization in the ICUs at Stanford Medical Center

Shohei Takatani (Stanford Health Care, USA)

March 2 (Sat) 8:45 ~ 9:35 Presentation Room 2 (Room A, Kyoto International Conference Center 2F)

Invited Lecture 11 (IL(E) 11) chaired by: Yasuhiro Kuroda (Kagawa University)

**Simultaneous translation between English and Japanese available*

Neurocritical care 2019: Recent advances and future frontiers

Stephan A. Mayer (Henry Ford Health System and the Mount Sinai Health System, USA)

March 2 (Sat) 9:40 ~ 10:30 Presentation Room 2 (Room A, Kyoto International Conference Center 2F)

Invited Lecture 12 (IL(E) 12) chaired by: Toshiaki Iba (Juntendo University)

**Simultaneous translation between English and Japanese available*

Sepsis: New insights into pathophysiology and a sneak preview to future therapy

Thomas van der Poll (Amsterdam University Medical Centers, University of Amsterdam, Netherlands)

March 2 (Sat) 10:35 ~ 11:25 Presentation Room 2 (Room A, Kyoto International Conference Center 2F)

Invited Lecture 13 (IL(E) 13) chaired by: Naoki Sato (Nippon Medical School)

**Simultaneous translation between English and Japanese available*

High sensitivity cardiac troponin assays: How they are being used across the world for the evaluation of patients with suspected acute coronary syndromes—Possible implications for Japan

Richard Michael Nowak (Henry Ford Hospital, USA)

March 2 (Sat) 14:00 ~ 14:50 Presentation Room 2 (Room A, Kyoto International Conference Center 2F)

Invited Lecture 14 (IL(E) 14) chaired by: Yoshiro Hayashi (Kameda Medical Center)

**Simultaneous translation between English and Japanese available*

An update of the subtleties of infection management in the ICU

Jeffrey Lipman (The University of Queensland Centre for Clinical Research, Australia)

March 2 (Sat) 14:55 ~ 15:45 Presentation Room 2 (Room A, Kyoto International Conference Center 2F)

Invited Lecture 15 (IL(E) 15) chaired by: Kaneyuki Kawamae (Yamagata University)

**Simultaneous translation between English and Japanese available*

Severe viral pneumonia: Significant?

Younsuck Koh (Asan Medical Center, University of Ulsan, Korea)

March 2 (Sat) 15:50 ~ 16:40 Presentation Room 2 (Room A, Kyoto International Conference Center 2F)

Invited Lecture 16 (IL(E) 16) chaired by: Chieko Mitaka (Juntendo University)

**Simultaneous translation between English and Japanese available*

Pick your syndrome: PICS or PIICS

Heatherlee Bailey (President Elect of SCCM)

March 2 (Sat) 8:45 ~ 9:35 Presentation Room 5 (Room D, Kyoto International Conference Center 1F)

Invited Lecture 17 (IL(E) 17) chaired by: Hideo Inaba (Kanazawa University)

**Simultaneous translation between English and Japanese available*

Volume management in ICU patients

Sung Jin Hong (Catholic University of Korea Yeouido St. Mary's Hospital, Korea)

March 2 (Sat) 9:40 ~ 10:30 Presentation Room 5 (Room D, Kyoto International Conference Center 1F)

Invited Lecture 18 (IL(E) 18) chaired by: Tetsu Gando (Sapporo Higashi Tokushukai Hospital)

End-of-life care, decision making and palliative care

Jozef Kesecioglu (University Medical Center Utrecht, Netherlands)

March 2 (Sat) 16:05 ~ 16:55 Presentation Room 6 (Swan, Kyoto International Conference Center 1F)

Invited Lecture 19 (IL(E) 19) chaired by: Hiroshi Morisaki (Keio University)

**In Japanese/Simultaneous translation NOT available*

Extracellular vesicles: ARDS と敗血症の新しいターゲット)

Masao Takata (Imperial College London, UK) 3

March 3 (Sun) 8:45 ~ 9:35 Presentation Room 5 (Room D, Kyoto International Conference Center 1F)

Invited Lecture 20 (IL(E) 20) chaired by: Naoki Sato (Nippon Medical School)

**Simultaneous translation between English and Japanese available*

Congestion in acute heart failure

Alexandra Mebazaa (University Hospitals Saint-Louis & Lariboisière, University of Paris, France)

March 3 (Sun) 11:15 ~ 12:05 Presentation Room 5 (Room D, Kyoto International Conference Center 1F)

Invited Lecture 21 (IL(E) 21) chaired by: Hiroshi Otake (Showa University)

**Simultaneous translation between English and Japanese available*

The challenge of medical artificial intelligence

Leo Anthony Celi (MIT Laboratory for Computational Physiology/Beth Israel Deaconess Medical Center, USA)

[SPECIAL PROGRAM]

March 1 (Fri) 14:00 ~ 15:00 Presentation Room 2 (Room A, Kyoto International Conference Center 2F)
Special Program 1 (SP1) chaired by: Masaji Nishimura

(President of JSICM/Tokushima Prefectural Central Hospital, Japan)

**Simultaneous translation between English and Japanese available*

-1 Current status of ICU and intensive care medicine in Japan

Masaji Nishimura (President of JSICM/Tokushima Prefectural Central Hospital, Japan)

-2 Current status of ICU and intensive care medicine in Korea

Sung Jin Hong (President of KSCCM/Catholic University of Korea Yeouido St. Mary's Hospital, Korea)

-3 Current status of ICU and intensive care medicine in Europe

Jozef Kesecioglu (President of ESICM/University Medical Center Utrecht, Netherlands)

-4 Current status of ICU and intensive care medicine in USA

Heatherlee Bailey (President Elect of SCCM)

-5 Current status of ICU and intensive care medicine in Thailand

Pusit Feungfoo (President Elect of TSCCM/Chitralada Vocational College, Thailand)

[MEET-THE-EXPERTS]

March 1 (Fri) 16:55 ~ 17:45 Presentation Room 2 (Room A, Kyoto International Conference Center 2F)
Meet-the-Experts 1 (ME1) chaired by: Masaji Nishimura

(President of JSICM/Tokushima Prefectural Central Hospital, Japan)

**Simultaneous translation between English and Japanese available*

Noninvasive Ventilation in Hypoxemic Acute Respiratory Failure

Massimo Antonelli (Catholic University of the Sacred Heart, Italy)

March 1 (Fri) 17:40 ~ 18:30 Presentation Room 5 (Room D, Kyoto International Conference Center 1F)

Meet-the-Experts 2 (ME2) chaired by: Gen Katsukawa (Japanese Society for Early Mobilization)

Osamu Nishida (Fujita Health University)

**Simultaneous translation between English and Japanese available*

Non-pharmacological management of delirium in the ICU: Understanding the latest evidence

Dale M. Needham (Johns Hopkins University, USA)

Céline Gélinas (McGill University, Canada) *as the commentator*

March 2 (Sat) 17:05 ~ 18:05 Presentation Room 5 (Room D, Kyoto International Conference Center 1F)

Meet-the-Experts 3 (ME3) chaired by: Toshiaki Iba (Juntendo University)

**Simultaneous translation between English and Japanese available*

-1 The coagulation system in sepsis and the application of anticoagulant therapy

Thomas van der Poll (Amsterdam University Medical Centers, University of Amsterdam, Netherlands)

-2 Kazuma Yamakawa (Osaka General Medical Center)

-3 Takeshi Wada (Hokkaido University)

March 2 (Sat) 17:15 ~ 18:25 Presentation Room 11 (Room C-2, Kyoto International Conference Center 1F)

Meet-the-Experts 4 (ME4) chaired by: Atsushi Kawaguchi (Montreal University)

**Simultaneous translation NOT available*

Moral distress: Video streaming "JUST KEEP BREATHING: A film about moral distress in ICU professionals"

Daniel Garros (University of Alberta Stollery Children's Hospital, Canada)

【SYMPOSIUM】

March 1 (Fri) 9:50 ~ 11:50 Presentation Room 2 (Room A, Kyoto International Conference Center 2F)
Symposium 1 (SY1) chaired by: Yuko Ikematsu (Nagoya University)
Toru Kotani (Showa University)

**Simultaneous translation between English and Japanese available*

- 1 Recent updates on safety and feasibility of rehabilitation and mobilization of critically ill adults
Dale M. Needham (Johns Hopkins University, USA)
- 2 Kensuke Nakamura (Hitachi General Hospital)
- 3 Shinichi Watanabe (Nagoya Medical Center)
- 4 Yusuke Kawai (Fujita Health University)
- 5 Toru Hosokawa (Nihon University)

March 1 (Fri) 9:15 ~ 11:15 Presentation Room 19 (Prince Hall 2, Grand Prince Hotel Kyoto B2F)
Symposium 6 (SY6) chaired by: Hiroshi Katayama (Kawasaki Medical School)
Joji Kotani (Kobe University)

**Simultaneous translation NOT available*

Adam Deane (Royal Melbourne Hospital, University of Melbourne, Australia) *as the commentator*

March 3 (Sun) 9:40 ~ 11:10 Presentation Room 5 (Room D, Kyoto International Conference Center 1F)
Symposium 18 (SY18) chaired by: Koichi Nakao (Saiseikai Kumamoto Hospital)
Osamu Nishida (Fujita Health University)

**Simultaneous translation between English and Japanese available*

- 1 Time is muscle: A universal scenario in the critically ill
Alexandra Mebazaa (University Hospitals Saint-Louis & Lariboisière, University of Paris, France)
- 2 Yasuyuki Kakihana (Kagoshima University)
- 3 Yasuyuki Shiraishi (Keio University)
- 4 Shiro Ishihara (Nippon Medical School)

【PANEL DISCUSSION】

March 2 (Sat) 14:00 ~ 15:30 Presentation Room 5 (Room D, Kyoto International Conference Center 1F)
Panel Discussion 7 (PD7) chaired by: Naoki Sato (Nippon Medical School)
Kenichi Matsuda (University of Yamanashi)

**Simultaneous translation between English and Japanese available*

- 1 Differentiating type 1 from type 2 acute myocardial infarction is necessary but can be difficult to do. A biomarker profile may be the answer.
Richard Michael Nowak (Henry Ford Hospital, USA)
- 2 Takashi Muroya (Kansai Medical University)
- 3 Tomonori Yamamoto (Osaka City University)
- 4 Kento Doi (University of Tokyo)
- 5 Kenichi Matsuda (University of Yamanashi)

【<Presidential Program> Lunchtime Seminar】

Ticket is required.

Ticket-vending machines are allocated near the registration desks and in the Main Entrance aisle of the Kyoto International Conference Center.

Tickets come to be invalid when the seminars start.

March 1 (Fri) 12:40 ~ 13:40 Presentation Room 11 (Room C-2, Kyoto International Conference Center 1F)

<Presidential Program> Lunchtime Seminar 1 (PLS1) chaired by: Satoru Hashimoto

(Kyoto Prefectural University of Medicine)

**Simultaneous translation NOT available*

Optimization of antibiotic therapy in the ICU

Jeffrey Lipman (The University of Queensland, Australia)

March 2 (Sat) 12:40 ~ 13:40 Presentation Room 11 (Room C-2, Kyoto International Conference Center 1F)

<Presidential Program> Lunchtime Seminar 2 (PLS2) chaired by: Shin Nunomiya (Jichi Medical University)

**Simultaneous translation NOT available*

What to consider when to set a mechanical ventilation

Younsuck Koh (Asan Medical Center, University of Ulsan, Korea)

【Educational Seminar (Luncheon)】

Ticket is required.

Ticket-vending machines are allocated near the registration desks and in the Main Entrance aisle of the Kyoto International Conference Center.

Tickets come to be invalid when the seminars start.

March 1 (Fri) 12:40 ~ 13:40 Presentation Room 2 (Room A, Kyoto International Conference Center 2F)

Educational Seminar (Luncheon) 2 (LS2) chaired by: Shin Nunomiya (Jichi Medical University)

**Simultaneous translation between English and Japanese available*

New Developments in Mechanical Ventilation Care

Marcelo Britto Passos Amato (University of São Paulo Heart Institute (INCOR) , Brazil)

March 2 (Sat) 12:40 ~ 13:40 Presentation Room 2 (Room A, Kyoto International Conference Center 2F)

Educational Seminar (Luncheon) 14 (LS14) chaired by: Toru Kotani (Showa University)

**Simultaneous translation between English and Japanese available*

Electrical impedance tomography for monitoring regional lung ventilation in critically ill patients

Inéz Frerichs (University Medical Centre Schleswig-Holstein, Germany)

March 2 (Sat) 12:40 ~ 13:40 Presentation Room 5 (Room D, Kyoto International Conference Center 1F)

Educational Seminar (Luncheon) 17 (LS17) chaired by: Shinhiro Takeda

(Kawaguchi Cardiovascular and Respiratory Hospital)

**Simultaneous translation between English and Japanese available*

NPPV: Pre-hospital and early use in acute pulmonary edema in Europe

Alexandra Mebazaa (University Hospitals Saint-Louis & Lariboisière, University of Paris, France)

March 3 (Sun) 12 : 40 ~ 13 : 40 Presentation Room 2 (Room A, Kyoto International Conference Center 2F)

Educational Seminar (Luncheon) 27 (LS27) chaired by: Masao Nagayama

(International University of Health and Welfare)

**Simultaneous translation NOT available*

Into the eye of the storm: Assessing brainstem distress with the pupilometer

Stephan A. Mayer (Henry Ford Health System and the Mount Sinai Health System, USA)

[TSCCM-JSICM Symposium]

📺 ライブ配信 (Live streaming available)

March 1, 2019 (Fri) 10:20 ~ 11:20 Room 11 (Room C-2/Kyoto International Conference Center 1F)

TSCCM-JSICM Symposium 1 (TJS1) 📺 Ethics and end of life

Chair Hidenobu Shigemitsu (Tokyo Medical and Dental University, Department of Intensive Care Medicine, Japan)
Dusit Staworn (Phramongkutklao College of Medicine, Thailand)

TJS1-1 Ethical conflicts in ICU Thailand

Dusit Staworn (Phramongkutklao College of Medicine, Thailand)

TJS1-2 Ethical conflicts in ICU Japan

Yasuhiro Norisue (Division of Critical Care Medicine, Tokyo Bay Urayasu Ichikawa Medical Center, Japan)

TJS1-3 Communication of palliative care in ICU: Listening to patient and family members of ICU patients

Chantana Morkchareonpong (National Cancer Institute of Thailand, Department of Medical Service, Ministry of Public Health, Thailand)

TJS1-4 Whose life is it, and who makes the choice between life and death?

Arino Yaguchi (Department of Critical Care and Emergency Medicine, Tokyo Women's Medical University, Japan)

March 1, 2019 (Fri) 11:25 ~ 12:25 Room 11 (Room C-2/Kyoto International Conference Center 1F)

TSCCM-JSICM Symposium 2 (TJS2) 📺 ECMO training

Chair Shigeki Fujitani (Emergency and Critical Care Medicine, St. Marianna University, Japan)

Suneerat Kongsayreepong (Department of Anesthesiology, Siriraj Hospital, Mahidol University, Thailand)

TJS2-1 ECMO: Our experiences in Thailand

Suneerat Kongsayreepong (Department of Anesthesiology, Siriraj Hospital, Mahidol University, Thailand)

TJS2-2 Development of ECMO, experience in Japan

Shingo Ichiba¹, Toshiyuki Aokage², Ichiro Takeuchi³, Satoshi Nakagawa⁴, Shinhiro Takeda⁵ (1. Department of Surgical Intensive Care Medicine, Nippon Medical School Hospital, Japan, 2. Okayama University Hospital, Department of Emergency and Critical Care Center, Japan, 3. Department of Emergency Medicine, Yokohama City University School of Medicine, Japan, 4. Department of Critical Care and Anesthesia, National Center for Child Health and Development, Japan, 5. Kawaguchi Cardiovascular and Respiratory Hospital, Japan)

TJS2-3 Initiating ECMO training program in Thailand

Sunthiti Morakul (Department of Anesthesiology, Ramathibodi Hospital, Mahidol University, Thailand)

TJS2-4 ECMO training program in Japan

Tomoyuki Endo¹, Shinichiro Oshimo² (1. Division of Emergency and Disaster Medicine, Tohoku Medical and Pharmaceutical University, Japan, 2. Hiroshima University Emergency and Critical Care Medicine, Japan)

March 1, 2019 (Fri) 15:10 ~ 16:25 Room 11 (Room C-2/Kyoto International Conference Center 1F)

TSCCM-JSICM Symposium 3 (TJS3) 📺 Mechanical ventilation

Chair Toru Kotani (Department of Intensive Care Medicine, Showa University, Japan)

Adisorn Wongsas (Phramongkutklao Hospital, Thailand)

TJS3-1 Weaning from mechanical ventilation in ARDS patients: Does automated weaning make our lives easier?

Tomomi Ueda (The Department of Anesthesiology, Keio University School of Medicine, Japan)

TJS3-2 Mechanical ventilation in ARDS

Adisorn Wongsas (Phramongkutklao Hospital, Thailand)

TJS3-3 Spontaneous breathing in ARDS

Takeshi Yoshida (The Department of Anesthesiology and Intensive Care Medicine, Osaka University Graduate School of Medicine, Japan)

TJS3-4 Trouble shooting in mechanical ventilation

Boonsong Patjanasoontorn (Division of Pulmonary and Critical Care Medicine, Department of Medicine, Khon Kaen University, Thailand)

TJS3-5 Biomarkers may predict outcomes in pediatric ARDS

Satoshi Nakagawa¹, Tho Bui², Phuc Phan Huu², Akira Aina³, Ikuyo Takayama³, Tadaki Suzuki³, Thuy Phung², Huong Do Thu², Hai Le Thanh², Noriko Nakajima³ (1. National Center for Child Health and Development, Japan, 2. National Children's Hospital, Vietnam, 3. National Institute of Infectious Diseases, Japan)

March 1, 2019 (Fri) 16:30 ~ 17:45 Room 11 (Room C-2/Kyoto International Conference Center 1F)

TSCCM-JSICM Symposium 4 (TJS4)  Perioperative critical care

Chair Moritoki Egi (Department of Anesthesiology, Kobe University Hospital, Japan)

Sahadol Poonyathawon (Department of Anesthesiology, Chulalongkorn University, Thailand)

TJS4-1 How to start up surgical ICU by internal physician intensivist

Go Haraguchi¹, Chieko Mitaka², Koichi Matsuo³, Takumi Nagao¹, Katsuaki Otsuki⁴, Morimasa Takayama⁵, Mitsuki Isobe⁵ (1. Division of Intensive Care Unit, Sakakibara Heart Institute, Japan, 2. Department of Anesthesiology, Juntendo University Hospital, Japan, 3. Division of Intensive Care Unit, New Tokyo Hospital, Japan, 4. Division of Intensive Care Unit, Tsuchiura Kyodo General Hospital, Japan, 5. Department of Cardiovascular Medicine, Sakakibara Heart Institute, Japan)

TJS4-2 Perioperative fluid therapy

Sahadol Poonyathawon (Department of Anesthesiology, Chulalongkorn University, Thailand)

TJS4-3 Perioperative nutrition therapy

Kaweesak Chittawatanarat (Department of Surgery, Chiang Mai University, Thailand)

TJS4-4 Perioperative respiratory management

Kiyoyasu Kurahashi (Department of Anesthesiology and Intensive Care Medicine, International University of Health and Welfare (IUHW), School of Medicine, Japan)

TJS4-5 Prevention of perioperative AKI

Kent Doi (Department of Acute Medicine, The University of Tokyo, Japan)

[English Session]

 ライブ配信 (Live streaming available)

March 1, 2019 (Fri) 9 : 00 ~ 10 : 00 Room 11 (Room C-2/Kyoto International Conference Center 1F)

English Session 1 (EngO1) 

Chair Sungwon Na (Department of Anesthesiology and Pain Medicine, Yonsei University College of Medicine, Korea)

- EngO1-1 External pressure to the calf region in contact with the boot-support-type leg holder system in the lithotomy position
Ju Mizuno¹, Toru Takahashi² (1. Department of Anesthesiology and Pain Medicine, Juntendo University Faculty of Medicine, Japan, 2. Faculty of Health and Welfare Science, Okayama Prefectural University, Japan)
- EngO1-2 Factorial analyses of incidental arterial line decannulation in the ICU
Noboru Hatakeyama, Masatoshi Okumura, Hideo Isobe, Atsushi Hashimoto, Kensuke Sakakibara, Yoshihito Fujita, Yoshihiro Fujiwara (Surgical Intensive Care Unit and Anesthesiology, Aichi Medical University, Japan)
- EngO1-3 Work related noise exposure and stress in intensive care unit
Seungho Jung, Jeongmin Kim, Sungwon Na (Department of Anesthesiology and Pain Medicine, Yonsei University College of Medicine, Korea)
- EngO1-4 Current status of pain and sedation therapy on noninvasive mechanical ventilation in Korean Intensive Care Units: a multi-center observational study
Taehee Kim¹, Jae Hwa Cho¹, Cheung Soo Shin², Jeong Soo Kim³, Sunghoon Park⁴, Korean Non-Invasive Ventilation Study Group (1. Department of Internal Medicine, Gangnam Severance Hospital, Yonsei University College of Medicine, Korea, 2. Department of Anesthesiology, Gangnam Severance Hospital, Yonsei University College of Medicine, Korea, 3. Department of Internal Medicine, Inha University College of Medicine, Korea, 4. Department of Pulmonary, Allergy and Critical Care Medicine, Hallym University Sacred Heart Hospital, Korea)
- EngO1-5 Utility of continuous monitoring and visualizing system for respiratory sounds
Kazuya Kikutani, Shinichiro Ohshimo, Shingo Ohki, Hiroshi Giga, Satoshi Yamaga, Takuma Sadamori, Nobuaki Shime (Department of Emergency and Critical Care Medicine, Graduate School of Biomedical & Health Sciences, Hiroshima University, Japan)
- EngO1-6 (Withdrawn)

March 1, 2019 (Fri) 14 : 00 ~ 15 : 00 Room 11 (Room C-2/Kyoto International Conference Center 1F)

English Session 2 (EngO2) 

Chair Fumimasa Amaya (Kyoto Prefectural University of Medicine, Japan)

- EngO2-1 Significance of intra aortic balloon pump in increasing the blood flow to the abdominal organs
Arudo Hiraoka, Genta Chikazawa, Kosuke Sakamoto, Toshinori Totsugawa, Kentaro Tamura, Hidenori Yoshitaka, Taichi Sakaguchi (Department of Cardiovascular Surgery, The Sakakibara Heart Institute of Okayama, Japan)
- EngO2-2 Effect of certified emergency life saving technicians for out-of-hospital cardiac arrest patients: A report from the JCS-ReSS study
Hiromichi Naito^{1,2}, Tetsuya Yumoto^{1,2}, Yoshio Tahara^{1,3}, Naohiro Yonemoto^{1,4}, Hiroshi Nonogi^{1,5}, Hiroaki Shimokawa^{1,6}, Ken Nagao^{1,7} (1. JCS-ReSS Group, Japan, 2. Okayama University Hospital, Advanced Emergency and Critical Care Medical Center, Japan, 3. Division of Coronary Disease, National Cerebral and Cardiovascular Center Hospital, Japan, 4. Department of Biostatistics, Kyoto University School of Public Health, Japan, 5. Shizuoka General Hospital, Japan, 6. Department of Cardiovascular Medicine, Tohoku University Hospital, Japan, 7. Nihon University Hospital, Cardiovascular Center, Japan)
- EngO2-3 Geographical differences on national meeting effect in patients with out-of-hospital cardiac arrests: A report from the JCS-ReSS study
Tetsuya Yumoto^{1,2}, Hiromichi Naito^{1,2}, Yoshio Tahara^{1,3}, Naohiro Yonemoto^{1,4}, Hiroshi Nonogi^{1,5}, Hiroaki Shimokawa^{1,6}, Ken Nagao^{1,7} (1. JCS-ReSS study group, Japan, 2. Department of Emergency, Critical Care, and Disaster Medicine, Okayama University Graduate School of Medicine, Dentistry and Pharmaceutical Sciences, Japan, 3. Division of Coronary Disease, National Cerebral and Cardiovascular Center Hospital, Japan, 4. Department of Biostatistics, Kyoto University School of Public Health, Japan, 5. Shizuoka General Hospital, Japan, 6. Department of Cardiovascular Medicine, Tohoku University Hospital, Japan, 7. Nihon University Hospital, Cardiovascular Center, Japan)
- EngO2-4 Are school hours associated with better outcomes of out-of-hospital cardiac arrest in school children?
Hideo Inaba¹, Akira Yamashita², Hisanori Kurosaki¹, Keisuke Ohta³, Yasuhiro Myojo³ (1. Department of Circulatory Emergency and Resuscitation Science, Kanazawa University Graduate School of Medicine, Japan, 2. Department of Cardiology, Noto General Hospital, Japan, 3. Emergency Medical Center, Ishikawa Prefectural Central Hospital, Japan)

EngO2-5 Extracorporeal cardiopulmonary resuscitation and damage control surgery for cardiac arrest due to postpartum hemorrhage

Kenshin Shimono¹, Hirokazu Onishi¹, Ryuji Sugimoto¹, Chiyoka Kosai², Masato Kamitomo², Takeshi Kodama³, Tsuyosi Ueno³, Junichiro Hamasaki³, Shohei Matsukubo¹, Hideaki Yoshihara¹ (1. Department of Emergency and Critical Care Center, Kagoshima City Hospital, Japan, 2. Department of Obstetrics and Gynecology, Kagoshima City Hospital, Japan, 3. Department of Critical Care Medicine, Kagoshima City Hospital, Japan)

EngO2-6 (Withdrawn)

March 2, 2019 (Sat) 8 : 45 ~ 9 : 45 Room 11 (Room C-2/Kyoto International Conference Center 1F)

English Session 3 (EngO3)

Chair Atsushi Kawaguchi (University of Montreal, Canada)

EngO3-1 Clinical analysis of prolonged mechanical ventilation > 72hrs following acute type A aortic dissection repair

Genta Chikazawa, Kentaro Tamura, Arudo Hiraoka, Toshinori Totsugawa, Atsuhisa Ishida, Satoko Ishii, Taichi Sakaguchi, Hidenori Yoshitaka (Department of Cardiovascular Surgery and Surgical ICU, The Sakakibara Heart Institute of Okayama, Japan)

EngO3-2 Measurement of esophageal pressure to assess extubation readiness in a neonate with congenital diaphragmatic hernia: its feasibility and usefulness

Masashi Taniguchi, Yu Inata, Takeshi Hatachi, Yoshiyuki Shimizu, Kazuya Tachibana, Muneyuki Takeuchi (Department of Intensive Care Medicine, Osaka Women's and Children's Medical Center, Japan)

EngO3-3 Current practice of high-flow nasal cannula-the pilot study

Je Hyeong Kim¹, Byun Ki Kim², Su A Kim¹, You Sang Ko³, Won Gun Kwack⁴, So Young Park⁵ (1. Department of Critical Care Medicine, Korea University Ansan Hospital, Korea, 2. Division of Pulmonology, Department of Internal Medicine, Korea University Ansan Hospital, Korea, 3. Division of Pulmonary, Allergy and Critical Care Medicine, Department of Internal Medicine, Kangdong Sacred Heart Hospital, Korea, 4. Division of Pulmonary, Allergy and Critical Care Medicine, Department of Internal Medicine, Kyung Hee University Hospital, Korea, 5. Department of Pulmonary and Critical Care Medicine, Chung Nam National University Medical Center, Korea)

EngO3-4 High-flow nasal cannula induced tension pneumocephalus

Youjin Chang¹, Tae-Gyu Kim², Sun-Yoon Chung³ (1. Division of Pulmonary and Critical Care Medicine, Department of Internal Medicine, Inje University College of Medicine, Sanggye Paik Hospital, Korea, 2. Department of Radiology, Inje University College of Medicine, Sanggye Paik Hospital, Korea, 3. Department of Neurosurgery, Inje University College of Medicine, Sanggye Paik Hospital, Korea)

EngO3-5 Effect of high-flow via non-rebreathing face mask compared to nasal cannula on nasopharyngeal CPAP, gas exchange and clinical outcome after extubation in surgical patients

Sunthiti Morakul¹, Pongrat Thungtitigul², Preeda Sumritpradit³, Pongsasit Singhatas³, Viratch Tangsujaritvijit⁴ (1. Department of Anesthesiology, Ramathibodi Hospital, Mahidol University, Thailand, 2. Critical care unit, Department of Medicine, Vajira Hospital, Navamindradhiraj University, Thailand, 3. Department of Surgery, Ramathibodi Hospital, Mahidol University, Thailand, 4. Pulmonary and Critical care unit, Department of Medicine, Ramathibodi Hospital, Mahidol University, Thailand)

EngO3-6 Effect of intraoperative PEEP setting guided by esophageal pressure measurement on oxygenation during laparoscopic gynecologic surgery

Annop Piriyaatsom, Sanchai Phetkampang (Department of Anesthesiology, Faculty of Medicine Siriraj Hospital, Mahidol University, Thailand)

March 2, 2019 (Sat) 9 : 50 ~ 10 : 50 Room 11 (Room C-2/Kyoto International Conference Center 1F)

English Session 4 (EngO4)

Chair Takashi Tagami (Department of Emergency and Critical Care Medicine, Nippon Medical School Tama Nagayama Hospital, Japan)

EngO4-1 Effectiveness of delta Saturation of brain tissue (StO₂) in pre-hospital settings: Pilot study

Jumpei Tsukuda, Takeshi Kawaguchi, Seitaro Sugawara, Kentaro Okamoto, Takaki Naito, Takuro Endo, Kenichiro Morisawa, Nobuhiko Shimozawa, Shigeki Fujitani, Yasuhiko Taira (Department of Emergency and Critical Care Medicine, St. Marianna University School of Medicine, Japan)

EngO4-2 Recognition of low body temperature and its association with outcome in bacteremic patients admitted to emergency and critical care center

Nobuaki Shime, Satoshi Yamaga (Department of Emergency and Critical Care Medicine, Hiroshima University, Japan)

- EngO4-3 Synergistic cytoprotection by co-treatment with dexamethasone and rapamycin against inflammatory cytokine-induced alveolar epithelial cell injury
Kyungho Chang¹, Ken Kuwajima², Ai Furuta², Masahiko Bougaki², Yoshitsugu Yamada², Shigehito Sawamura¹ (1. Anesthesiology and Intensive Care Unit, Teikyo University School of Medicine, Japan, 2. Anesthesiology and Pain Relief Center, University of Tokyo Hospital, Japan)
- EngO4-4 Crucial role of IL-1R signaling in neutrophils to increase lung permeability in LPS/mechanical ventilation acute lung injury
Nobuyuki Nosaka, Timothy R Crother, Shuang Chen, Moshe Arditi, Kenichi Shimada (Department of Pediatrics, Cedars-Sinai Medical Center, USA)
- EngO4-5 Mortality prediction among sepsis patients using a combination of qSOFA, National Early Warning Score, age, gender and serum lactate levels
Chie Tanaka, Takashi Tagami, Shin Sato, Akiko Takehara, Junya Kaneko, Reo Fukuda, Saori Kudo, Masamune Kuno, Kyoko Unemoto (Department of Emergency and Critical Care Medicine, Nippon Medical School Tamanagayama Hospital, Japan)
- EngO4-6 Nebulized adrenaline attenuates lung alveolar and interstitial edema compared to phenylephrine and salbutamol in ovine burn and smoke inhalation injury model
Satoshi Fukuda^{1,2}, Koji Ihara^{1,3}, Yosuke Niimi^{1,3}, Ernesto Lopez¹, Keibun Liu¹, Clark R. Andersen^{1,4}, Robert A. Cox^{2,5}, David N. Herndon^{1,2}, Donald S. Prough^{1,2}, Perenlei Enkhbaatar^{1,2} (1. Department of Anesthesiology, University of Texas Medical Branch at Galveston, USA, 2. Shriners Hospital for Children, USA, 3. Department of Plastic and Reconstructive Surgery, Tokyo Women's Medical University, Japan, 4. Department of Preventive Medicine & Community Health, Office of Biostatistics, University of Texas Medical Branch, Galveston, USA, 5. Department of Pathology, University of Texas Medical Branch, Galveston, USA)

March 2, 2019 (Sat) 10 : 55 ~ 11 : 55 Room 11 (Room C-2/Kyoto International Conference Center 1F)

English Session 5 (EngO5)

Chair Hideo Inaba (Department of Circulatory Emergency and Resuscitation Science, Kanazawa University Graduate School of Medicine, Japan)

- EngO5-1 Feeding practices of mechanically ventilated intensive care patients: an evaluation of overfeeding and clinical outcomes
Aiko Tanaka^{1,2}, Kate Hamilton³, Glenn Eastwood², Daryl Jones², Rinaldo Bellomo² (1. Department of Anesthesiology and Intensive Care Medicine, Osaka University, Japan, 2. Department of Intensive Care, Austin Hospital, Australia, 3. Nutrition and Dietetic Department, Austin Hospital, Australia)
- EngO5-2 Efficacy and safety of fibrinogen concentrate in patients with hemorrhagic shock: a single-center experience
Masakazu Nitta, Hiroshi Endoh, Tadayuki Honda, Hiroki Shimizu, Hiroyuki Honda, Yoshifumi Hoshino, Takashi Hazama, Natsuo Kamimura (Niigata University Medical and Dental Hospital, Advanced Disaster Medicine and Emergency Critical Care Center, Japan)
- EngO5-3 Circulating activated protein C levels in septic patients treated with recombinant human soluble thrombomodulin
Takuro Arishima¹, Takashi Ito^{1,2}, Tomotsugu Yasuda¹, Nozomi Yashima³, Chinatsu Kamikokuryo³, Hiroaki Furubeppu¹, Takahiro Futatsuki¹, Hiroyuki Haraura¹, Ikuro Maruyama², Yasuyuki Kakahana^{1,3} (1. Emergency and Critical Care Center, Kagoshima University Hospital, Japan, 2. Systems Biology in Thromboregulation, Kagoshima University Graduate School of Medical and Dental Sciences, Japan, 3. Emergency and Intensive Care Medicine, Kagoshima University Graduate School of Medical and Dental Sciences, Japan)
- EngO5-4 Association of liver enzyme with morbidity and mortality in traumatic liver injury patients
Ginhasuphang Wangsaphawi, Kaweesak Chittawatanarat (Division of Surgical Critical Care and Trauma, Department of Surgery, Faculty of Medicine, Chiang Mai University, Thailand)
- EngO5-5 A new predictive equation for resting energy expenditure in mechanically ventilated Thai patients
Phoonsak Limraksasin¹, Naplika Kongpolprom² (1. Division of Critical Care Medicine, Department of Anesthesiology, King Chulalongkorn Memorial Hospital, Thailand, 2. Division of Pulmonary and Critical Care Medicine, Department of Medicine, King Chulalongkorn Memorial Hospital, Thailand)
- EngO5-6 Comparison of measured energy expenditure using indirect calorimetry versus predictive equations for liver transplant recipients
Seok-Joon Lee¹, Hak-Jae Lee², Yooun-Joong Jung², Minkyu Han³, Suk-Kyung Hong² (1. College of Medicine, University of Ulsan, Korea, 2. Division of Acute Care Surgery, Department of Surgery, University of Ulsan College of Medicine, Asan Medical Center, Korea, 3. Department of Clinical Epidemiology and Biostatistics, University of Ulsan, Korea)

March 2, 2019 (Sat) 14 : 00 ~ 15 : 00 Room 11 (Room C-2/Kyoto International Conference Center 1F)

English Session 6 (EngO6)

Chair Takeshi Suzuki (Department of Anesthesiology, Keio University School of Medicine, Japan)

- EngO6-1 Evaluation of clinical pharmacist intervention in surgical intensive care unit
Jiyoung Kim, Jonghee Ko, Soohyun Kim, Eunsun Son, Jeongmin Kim, Sungwon Na (Department of Pharmacy, Anesthesiology and Pain Medicine, Yonsei University College of Medicine, Korea)
- EngO6-2 A unique strategy for large bowel perforation with ventriculo-peritoneal shunt: Conversion to ventriculo-atrial shunt
Shota Akabane, Hirokazu Iijima, Shoichi Nakajima, Yukari Kobayashi, Kazunao Watanabe (Tokyo Nishi Tokushukai Hospital, Japan)
- EngO6-3 Influenza-associated septic shock accompanied by septic cardiomyopathy that developed in summer and mimicked fulminant myocarditis
Kei Suzuki, Ryo Esumi, Kaoru Ikejiri, Asami Ito, Yoshiaki Iwashita, Ken Ishikura, Masaki Fujioka, Hiroshi Imai (Mie University Hospital, the Emergency and Critical Care Center, Japan)
- EngO6-4 Association between appropriate empiric antimicrobial therapy and mortality from bloodstream infections in the intensive care unit
Satoshi Yamaga, Nobuaki Shime, Shinichiro Ohshimo (Department of Emergency and Critical Care Medicine, Graduate School of Biomedical and Health Sciences, Hiroshima University, Japan)
- EngO6-5 Effect of healthcare-associated infections on the length of pediatric intensive care unit stay
Takeshi Hatachi, Jumpei Okumura, Kota Yoshida, Mami Yamada, Takaaki Akamatsu, Masashi Taniguchi, Jun Takeshita, Kanako Isaka, Kazue Moon, Muneyuki Takeuchi (Osaka Women's and Children's Hospital, Japan)
- EngO6-6 Open label prospective randomised control study of high cut point level of procalcitonin guided antibiotic therapeutic protocol in surgical critically ill patients
Kaweesak Chittawatananarat, Narain Chotirosniramit, Kamtone Chandacham, Tidarat Jirapongcharoenlap, Rungnapa Peerakam, Mudjaln Areerug (Division of Surgical Critical Care and Trauma, Department of Surgery, Faculty of Medicine, Chiang Mai University, Thailand)

March 2, 2019 (Sat) 15 : 05 ~ 16 : 05 Room 11 (Room C-2/Kyoto International Conference Center 1F)

English Session 7 (EngO7)

Chair Kenji Wakabayashi (Department of Intensive Care Medicine, Tokyo Medical and Dental University, Japan)

- EngO7-1 Characteristics of wound infections among patients injured during torrential rain and landslides, in the 2018 disaster in west Japan
Kazuya Kikutani¹, Michihito Kyo¹, Junji Itai¹, Shinji Kusunoki², Takao Yamanoue², Yasumasa Iwasaki³, Itsuo Nakagawa⁴, Hiroshi Naitou⁵, Masami Ishikawa⁶, Nobuaki Shime¹ (1. Department of Emergency and Critical Care Medicine, Graduate School of Biomedical and Health Sciences, Hiroshima University, Japan, 2. Emergency Department, Hiroshima Prefectural Hospital, Japan, 3. Emergency Department, Kure Medical Center and Chugoku Cancer Center, Japan, 4. Emergency Department, Chugoku Rosai Hospital, Japan, 5. Department of Emergency Medicine, Hiroshima Citizens Hospital, Japan, 6. Emergency Department, Kure Kyosai Hospital, Japan)
- EngO7-2 Potential benefits of acute-phase cardiac rehabilitation in the intensive care unit for patients with cardiovascular disease -A retrospective observational study-
Nobuaki Hamazaki¹, Ryota Matsuzawa¹, Kohei Nozaki¹, Takafumi Ichikawa¹, Kentaro Kamiya², Kazumasa Miida¹, Tomotaka Koike³, Emi Maekawa⁴, Masayasu Arai⁵, Takashi Masuda² (1. Department of Rehabilitation, Kitasato University Hospital, Japan, 2. Department of Rehabilitation, Kitasato University School of Allied Health Sciences, Japan, 3. Intensive Care Center, Kitasato University Hospital, Japan, 4. Department of Cardiovascular Medicine, Kitasato University School of Medicine, Japan, 5. Department of Anesthesiology, Kitasato University School of Medicine, Japan)
- EngO7-3 Influencing factors on the changes of ICU family members' satisfaction
Soyoung Yang¹, Hye Ri Choi³, In-Ho Yang¹, Mira Song¹, Jun Ki Min¹, Minji Lee¹, Yee Hyung Kim², Sung Wook Kang² (1. Department of Internal Medicine, Kyung Hee University Hospital at Gang Dong, Korea, 2. Department of Pulmonary and Critical Care Medicine, Kyung Hee University Hospital at Gang Dong, Korea, 3. School of Health in Social Science, University of Edinburgh, UK)
- EngO7-4 Intergrated clinical reasoning assessment in simulation crisis management class
Kanya Kumwilaisak¹, Toonchai Indrambarya¹, Danai Wangsaturaka², Paweenuch Bootjeamjai¹ (1. Division of critical care, Department of Anesthesiology, King Chulalongkorn Memorial Hospital, Thailand, 2. Department of Pharmacology Faculty of Medicine, Chulalongkorn University, Thailand)

- EngO7-5 The epidemiology and characteristics of acute kidney injury in the intensive care unit in resource limited settings: A prospective multicenter study
Nattachai Srisawat^{1,2}, Win Kulvichit^{1,2}, Noppathorn Mahamitra¹, Cameron Hurst³, Kearkiat Praditpornsilpa¹, Nuttha Lumlertgul¹, Kriang Tungsanga¹, Somchai Eiam-Ong¹, Visith Sitprija^{1,4}, John A Kellum², Konlawij Trongtrakul⁵, SEA-AKI study group (1. Division of Nephrology, Department of Medicine, Faculty of Medicine, Chulalongkorn University, and King Chulalongkorn Memorial Hospital, Thailand, 2. Center for Critical Care Nephrology; The CRISMA Center, Department of Critical Care Medicine, University of Pittsburgh School of Medicine, USA, 3. Statistics Unit, QIMR Berghofer Medical Research Institute, Australia, 4. Queen Saovabha Memorial Institute, Thai Red Cross, Thailand, 5. Vajira Hospital, Navamindradhiraj University, Thailand)
- EngO7-6 Predictive factors of abnormal finding detected by computerized tomography scan of brain among medical critically ill patients
Surat Tongyoo¹, Meitee Vichutavate¹, Tipa Chakorn², Chairat Permpikul¹ (1. Department of Internal Medicine, Faculty of Medicine, Siriraj Hospital, Mahidol University, Thailand, 2. Department of Emergency Medicine, Faculty of Medicine, Siriraj Hospital, Mahidol University, Thailand)

March 2, 2019 (Sat) 16 : 10 ~ 17 : 10 Room 11 (Room C-2/Kyoto International Conference Center 1F)

English Session 8 (EngO8)

Chair Takaki Naito (Department of Emergency and Critical Care Medicine, St. Marianna University School of Medicine, Japan)

- EngO8-1 Newly introduced educational program on coping with ICU surge during the Mass Casualty Incident
Takamitsu Kodama¹, Eiji Kawamoto², Yasuhiro Irie³, Yoichi Kase⁴, Masashi Nakagawa⁵ (1. Aichi Medical University, Center for Disaster Medical Sciences, Japan, 2. Mie University Hospital, Medical Emergency Center, Japan, 3. Seirei Yokohama Hospital, Department of Emergency Medicine, Japan, 4. Jikei University Kashiwa Hospital, Department of Anesthesiology, Japan, 5. Tokyo Women's Medical University, Department of Intensive Care Medicine, Japan)
- EngO8-2 Development of an easy-to-use questionnaire for critical care nursing competence related to patient safety in Japan: a cross-sectional study
Masatoshi Okumura¹, Tomonori Ishigaki², Kazunao Mori¹, Yoshihiro Fujiwara¹ (1. Department of Anesthesiology, Aichi Medical University, Japan, 2. Department of Business Administration, Nanzan University, Japan)
- EngO8-3 The patient's life inside hospital difference between Japan and Thailand
Nobuichiro Tamura¹, Tawatchai Impoo² (1. Kurashiki Central Hospital, Japan, 2. KhonKaen Hospital, Thailand)
- EngO8-4 Successful management fatal systemic air embolism of CT-guided lung biopsy: Case report
Yi-Pin Chou^{1,3,4}, Tung-Ho Wu^{2,3}, Hsing-Lin Lin³ (1. Division of Thoracic Surgery, Department of Surgery, Veterans General Hospital, Taiwan, 2. Division of Cardiovascular Surgery, Department of Surgery, Veterans General Hospital, Taiwan, 3. Department of Critical Care Medicine, Veterans General Hospital, Taiwan, 4. Division of Trauma, Department of Emergency, Veterans General Hospital, Taiwan)
- EngO8-5 Trauma system including trauma center: a death review from premature trauma center in Korea
Byungchul Yu, Mina Lee, Giljae Lee, Jungnam Lee (Gachon University Gil Medical Center, Korea)
- EngO8-6 Effects of an isotonic balanced sodium solution and acetated Ringer's solution on the incidence of hyponatremia in patients who have cardiac surgery
Sunthiti Morakul¹, Naruemol Prachanpanich¹, Piyarat Sittiwanna¹, Sumethee Jiraratkul² (1. Department of Anesthesiology, Faculty of Medicine, Ramathibodi Hospital, Mahidol University, Thailand, 2. Department of Surgery, Faculty of Medicine, Ramathibodi Hospital, Mahidol University, Thailand)